

Norwell Public Library Parking Plan:

The parking plan includes a total of 65 parking spaces. There are 56 patron spaces, 3 of which are accessible in compliance with ADA guidelines, and 9 staff parking spaces. An additional 6 existing parking spaces can be kept if needed. Patron parking spaces and 2 of the accessible spaces are located in front of the library. Staff parking spaces and the 3rd accessible space are located on the side of the library near the staff entrance. All parking spaces are dedicated for library parking. This parking plan conforms to the MBLC guideline of one parking space per 400 gross square feet of building, not including staff parking. With regard to local zoning restrictions, section 1610 of the Norwell Zoning Bylaws states that "a municipal project that is approved by Town Meeting, is effectively exempt from the requirements of the Norwell Zoning Bylaw."

NO.	DATE	DESCRIPTION
1	10/20/16	REVISION 1
2	10/20/16	REVISION 2

CD PROJ. # 148
 FILE NAME: PL_LANDSCAPE
 DRAWN BY: GS
 CHECKED BY: GS
 DATE: 10/20/16

SCALE: 1"=20'-0"



SHEET TITLE:
SITE PLAN

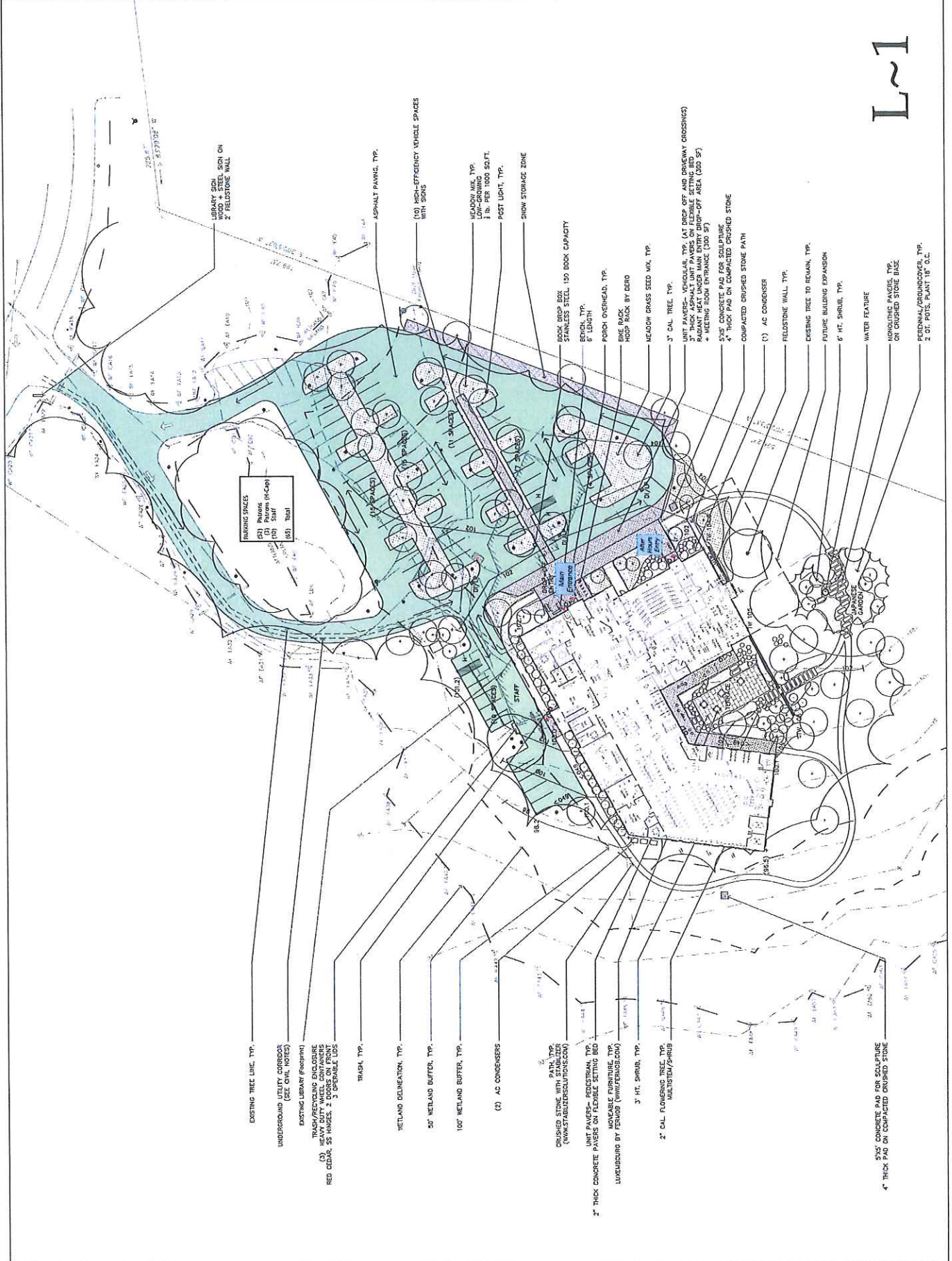

L~1