

CONCEPT DESIGN

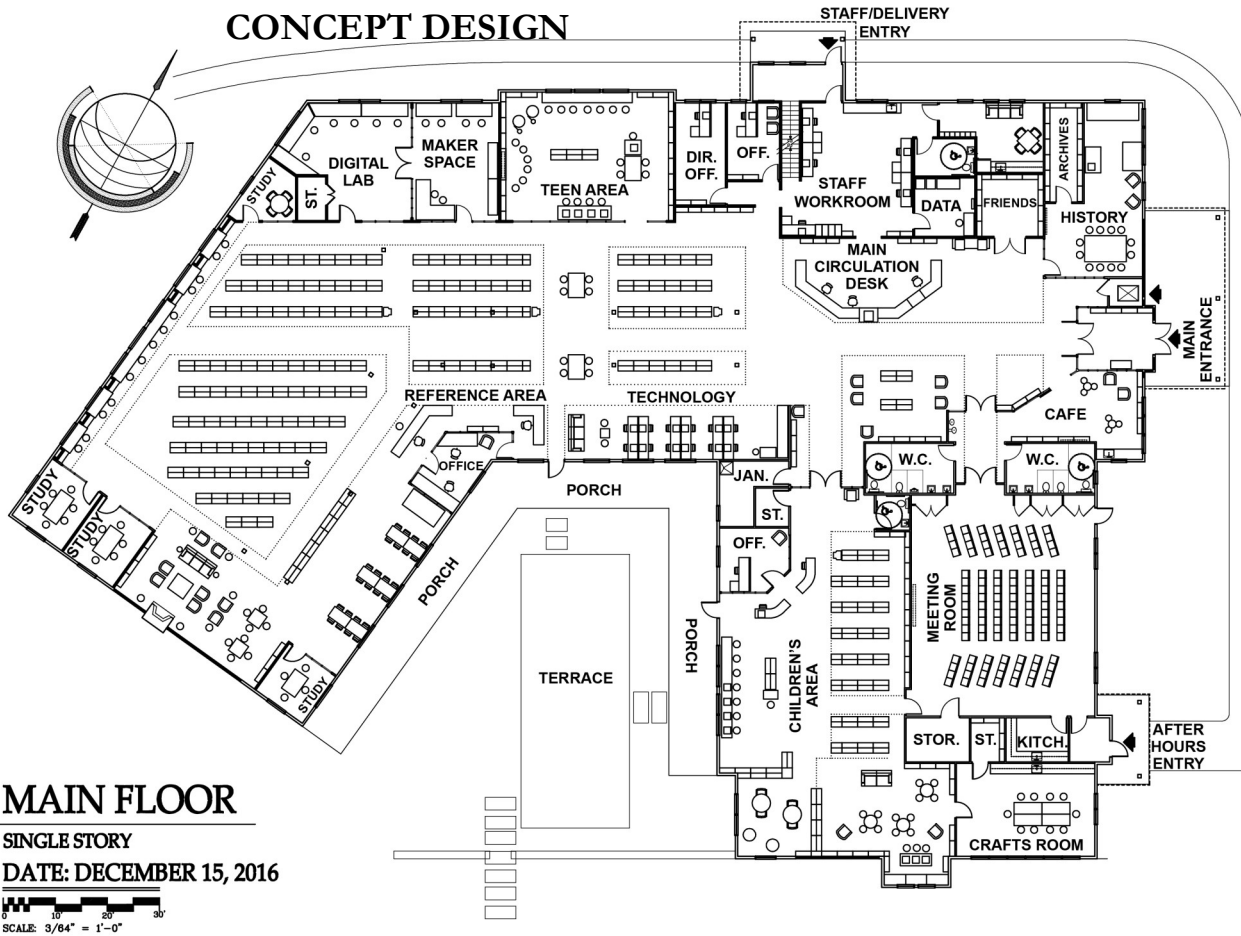

MAIN FLOOR

SINGLE STORY
DATE: DECEMBER 15, 2016

SCALE: 3/64" = 1'-0"

Estimated Project Cost:

Estimated total cost:	\$15.4 M
- Provisional Construction grant *	- 6.4 M
- Library trust fund	- 0.3 M
- Feasibility Study (Paid)	- 0.1 M
Estimated town investment	\$ 8.6 M

Town investment may be reduced by up to \$1M through a capital campaign.

* Norwell has been awarded a \$6.4 million provisional construction grant through the Massachusetts Public Library Construction Program.

To receive these grant funds, Norwell must secure local funding approval at the Special Town Meeting on December 4, 2017 and Special Election on December 9, 2017.

To learn more, visit norwellpubliclibrary.org and go to the *Building Project* page. Questions?

Contact Norwell Public Library Director Judy McConarty at 781-659-2015 x111 or jmcconarty@ocln.org.

SPACE COMPARISON

SPACE	CURRENT LIBRARY	PROPOSED LIBRARY
BUILDING	BUILT IN 1974 <ul style="list-style-type: none"> 8,500 Square Feet (plus mechanical) One story Limited accessibility Aging building systems not energy efficient 	NEW BUILDING <ul style="list-style-type: none"> 20,800 Square Feet (plus mechanical) One story Fully accessible Energy efficient, designed to LEED Silver standard
PARKING	28 SPACES	65 SPACES
COLLECTION SPACE	<ul style="list-style-type: none"> Inadequate for collection size Shelving overflow in meeting room 	<ul style="list-style-type: none"> Adequate space for all collections Mobile shelving provides flexibility
MEETING ROOM	CAPACITY < 100 <ul style="list-style-type: none"> Available space reduced by collection & storage No gallery space No after-hrs use 	CAPACITY = 120 <ul style="list-style-type: none"> Kitchen facilities Storage space Gallery space Designed to allow for after-hrs use
SMALL MTG STUDY RMS	NONE	4 ROOMS <ul style="list-style-type: none"> Each seats 4 or 6
LOCAL HISTORY ROOM	NONE	LOCAL HISTORY ROOM <ul style="list-style-type: none"> Collection space Conference space
TECH & MAKER LAB	NONE	TECH/MAKER LAB <ul style="list-style-type: none"> Experiential learning Tech instruction
CHILDRENS ROOM	OPEN AREA (1,200 SF) <ul style="list-style-type: none"> Cramped with inadequate seating & collection space No room for kids' programs 	ENCLOSED ROOM (3,000+ SF) <ul style="list-style-type: none"> More seating & collection space Includes Children's Program Room Family restroom
TEEN ROOM	OPEN AREA (250+ SF) <ul style="list-style-type: none"> Not teen friendly Inadequate size and resources for this age group 	ENCLOSED ROOM (780+ SF) <ul style="list-style-type: none"> Separate teen space More seating, technology, and collection space

Norwell Public Library is a Community Gathering Place

- Norwell Education Foundation
- Norwell High School Parents Coalition
- Norwell Scholastic Arts Society
- Norwell Town Democratic/Republican Committees
- Norwell Garden Club * Norwell Farms
- Plymouth County 4-H Club
- Friendship Home Book Group
- Tutoring Sessions * Study Groups
- Girl Scouts * Cub Scouts * Troop Leaders
- Nordland AMPS Hobby Group
- South Shore Lacrosse League * Youth Chorus
- Norwell Chamber of Commerce
- College Interviews * Business meetings
- Neighborhood Associations * Norwell Moms Club
and more...

Norwell Public Library is a Center for Lifelong Learning

- Book Discussion Groups * Author Talks
- Independent/Foreign Films * Gardening Programs
- Estate Planning * Stress Management * Tai Chi
- Summer Reading Program * STEM Workshops
- Norwell Reads* Community Reading Events
- Story Times/Early Childhood Literacy
- Elder Care Series * Opioids Panel Discussion
- Makerspace* Experiential Learning Projects
- Photography Workshops * Art/Music Programs
- Genealogy Workshops * Internet Safety
and more...



Norwell Public Library Proposed Building Project

Information Sessions

Tuesday, November 7, 2017
2:30 pm & 6:30 pm

Norwell Public Library Meeting Room

Special Town Meeting

Monday, December 4, 2017
7:30 pm

Norwell Middle School

Special Election

Saturday, December 9, 2017
8:00 am to 6:00 pm

Norwell Middle School



Norwell Public Library

Branch out – at your library!

10/18/17

NPL is busier than ever!

Last year:

- There were 70,000 in-person library visits
- 4,700 Norwell residents had active library cards, averaging more than 1 per household
- Staff answered 5,000 reference questions
- Over 120,000 items were checked out
- The meeting room was used 400 times
- 6,000 attendees, including kids, teens, and adults, enjoyed over 300 programs

Library use has grown since the current building opened in 1975. Beyond increases in collection size and circulation, the library serves now more than ever as a community gathering place and center for lifelong learning.

Library Use	1975	2017	Increase
Collection	18,000	62,000	240 %
Circulation	75,000	120,000	60 %
Program Attendance	1,700	6,000	250%

The current building, now over 40 years old with much of its infrastructure past its useful life, is one of the smallest library buildings in the state in Norwell's population group. The building is no longer adequate to meet the needs of the community or to provide the resources of a 21st century public library.

The proposed library building project responds to this challenge with a new, larger building that is designed not only to accommodate the library's collection, but to provide space for the community to gather, learn, create, share, and grow.